



*Galtech* s.r.l  
Gruppo Gallinari

[www.galtech.it](http://www.galtech.it)

Range of Products :  
Gear Pumps and Motors



## Pumps and gear motors

Galtech is specialized in pumps production from group 1 to group 3, divided into 29 displacements: from 0,9 to 62 cc, and up to 320 bar of max working pressure.

Pumps are available with cast iron flanges and covers version to reduce the loudness level.

Each pump can be assembled whether with standard flanges (European, German or SAE) or with special ones (ZF, Perkins and Renault), with conic, cylindrical or splined shafts.

Furthermore it is possible to assemble covers with pressure relief valves and flow control valves. All standard pumps are arranged with back tow for one or more pumps, using the coupling kits, available also in the short version and or high and low pressure.

All production lines are:

- Gear Pumps with alluminium flanges and covers
- Gear Pumps with cast iron flanges and covers
- Gear Motor with alluminium flanges and covers
- Gear Motor with cast iron flanges and covers
- Hand Pumps

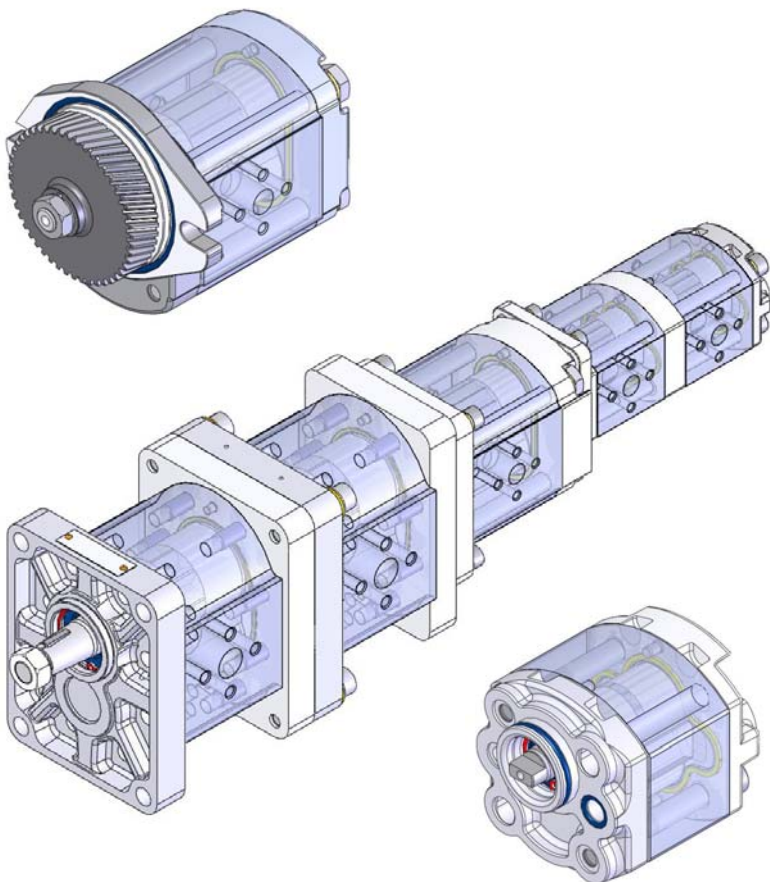

## Available types of Pumps or Gear Motor:

### POMPE GRUPPO PUMPS GROUP 1



### POMPE GRUPPO PUMPS GROUP 2

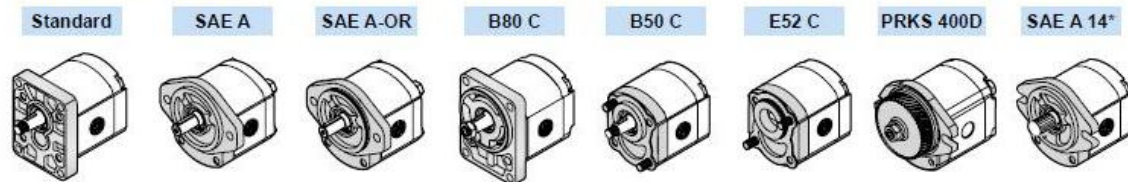

### POMPE GRUPPO PUMPS GROUP 3

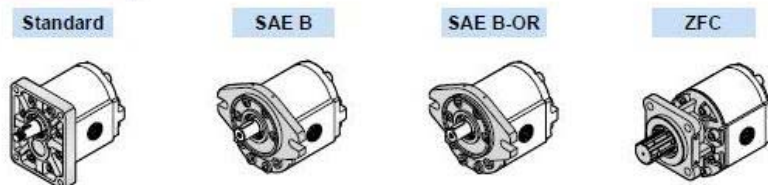

## Displacements :

### Group 1

-0.9 cc  
-1.2 cc  
-1.6 cc  
-2.0 cc  
-2.5 cc  
-3.2 cc  
-3.7 cc  
-4.2 cc  
-5.0 cc  
-6.3 cc  
-7.8 cc  
-9.8 cc

### Group 2

-4 cc  
-6 cc  
-8 cc  
-11 cc  
-14 cc  
-16 cc  
19 cc  
22 cc  
26 cc

### Group 3

-19 cc  
-22 cc  
-29 cc  
-33 cc  
-36 cc  
-44 cc  
-52 cc  
-62 cc

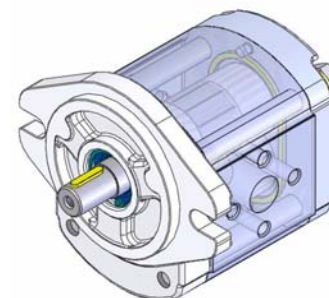
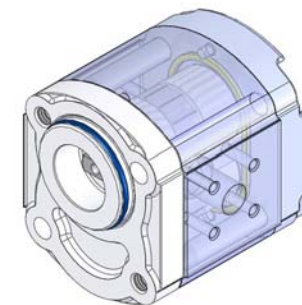



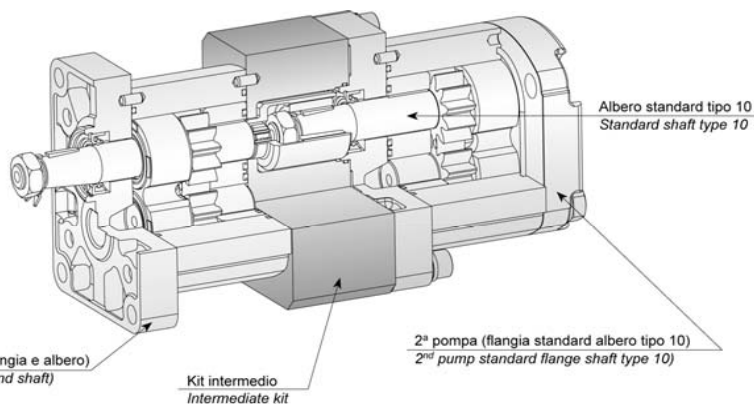

## Multiple gear pumps

Multiple pumps are available in two or more stadium, and can be assembled in these execution:

- Standard tandem
- Short tandem (reduced axial dimension respect standard tandem, shared suction between all the pumps)
- Short tandem for high and low pressure (with low pressure pump exclusion valve)

The versatility of our pumps permits to assembly a multiple pump using single pumps making only a simply operation of disassembly / assembly, thanks to the predisposition of each pump to engage another pump and thanks to the availability of "flange connections and accessories" kits.

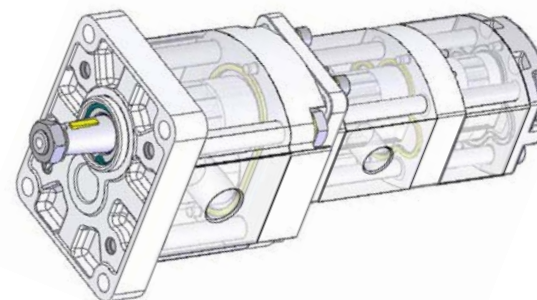
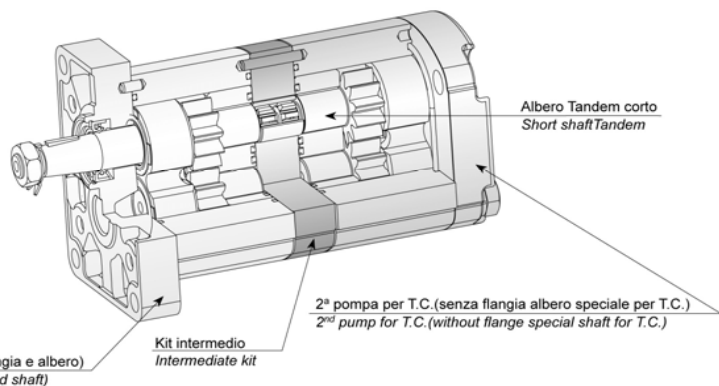

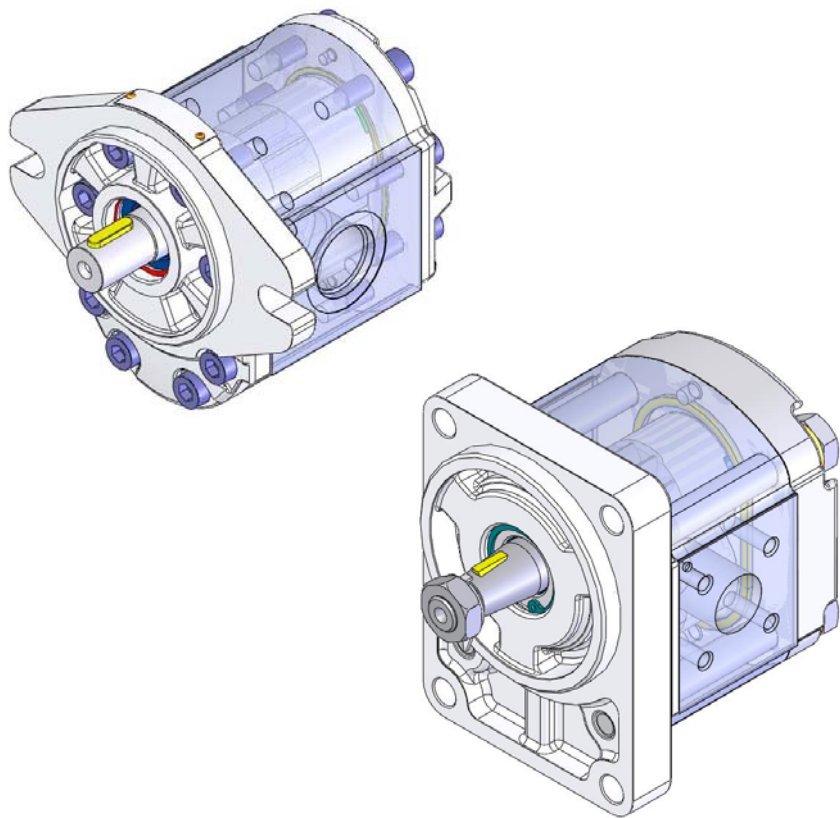

## Gear Motors

Motors with external gears from group 2 to group 3, divided into 17 displacements from 4 to 61,1cc, up to 270 bar of max working pressure and maximum speed up to 4000 rpm, with hydrostatic balance to reduce the axial slack.

Gear motors are available in unidirectional and reversible versions (reversible motors can be used same in series circuit).

Each motor can be assembled with standard flanges (European, German or SAE) or with special ones (ZF, Perkins and Renault), with conic, cylindrical or splined shaft. Furthermore it is possible to assemble covers with two speed function and with pressure relief valve.



## Inversione del senso di rotazione - *Wise rotation reversal*

- \* Nelle pagine relative ai dati tecnici sono specificati gli attacchi in funzione del senso di rotazione S o D preconfigurato.  
*The technical data pages specify the connections depending on the preconfigured rotation direction (L or R).*

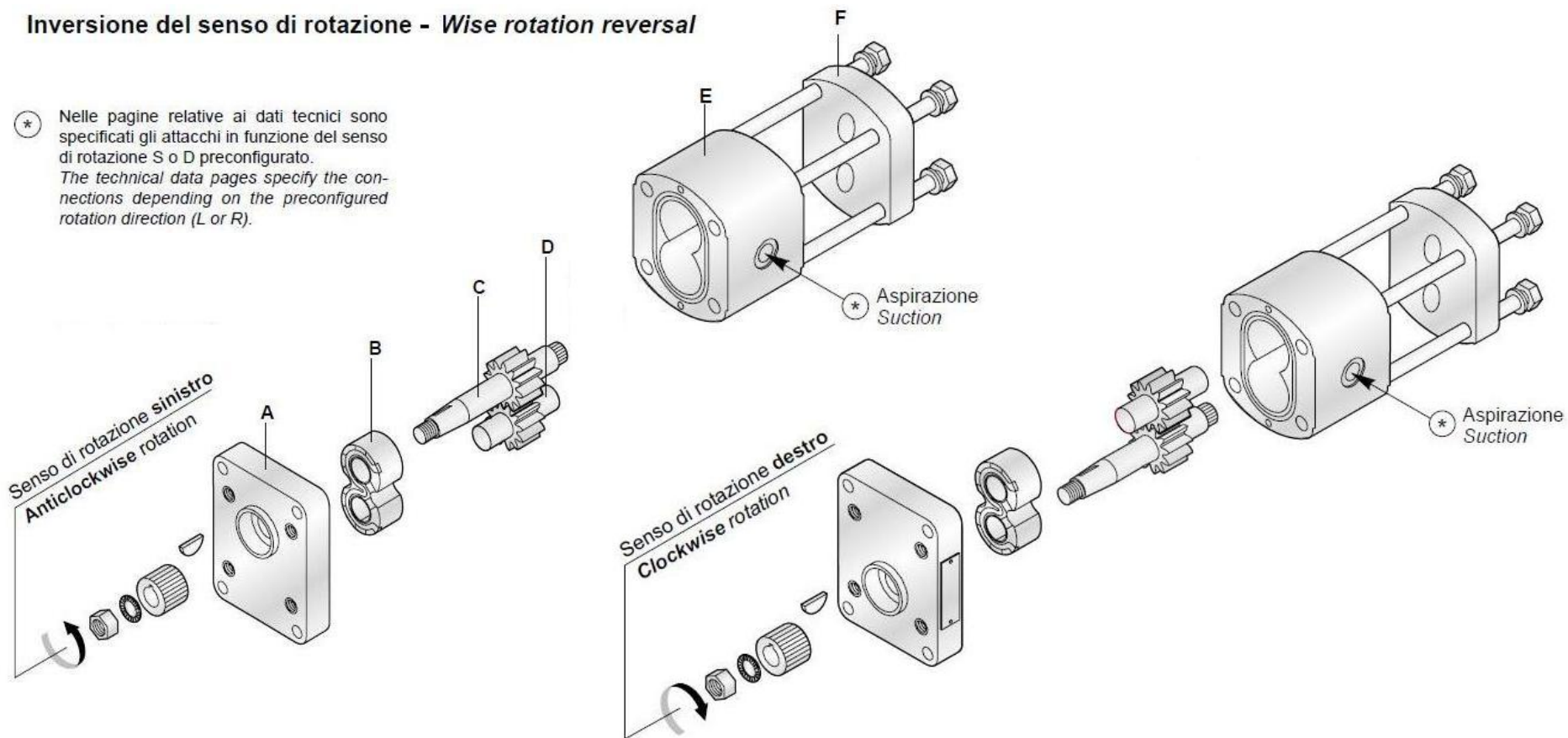



## Available Shafts and connections :

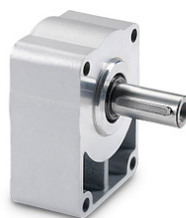
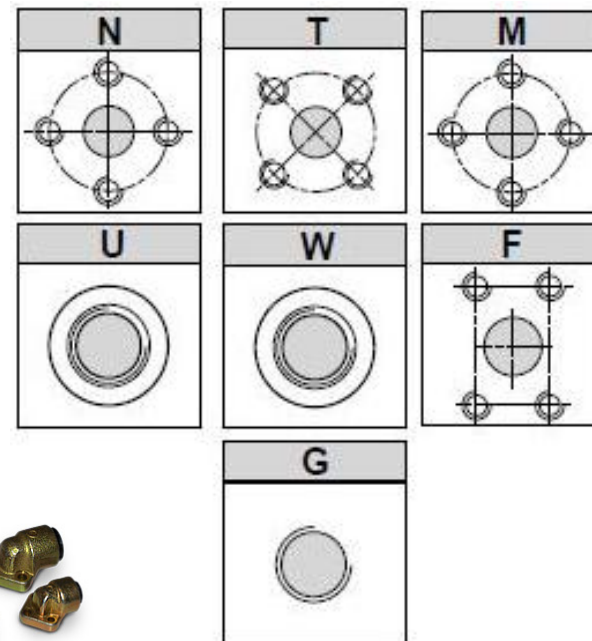
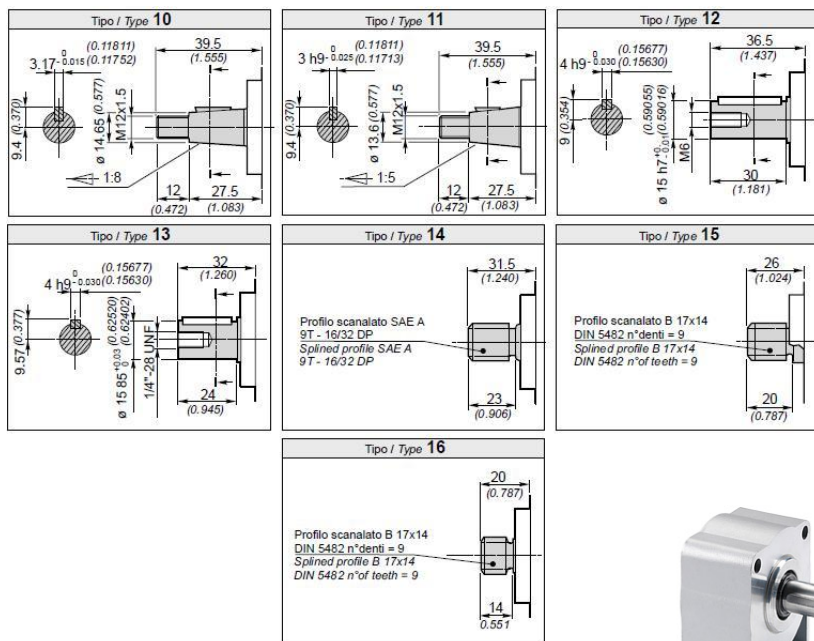

## Optional Valves

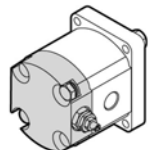

- Pressure relief valve with internal exhaust
- Pressure relief valve with external exhaust

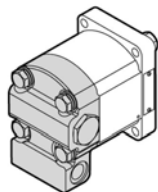
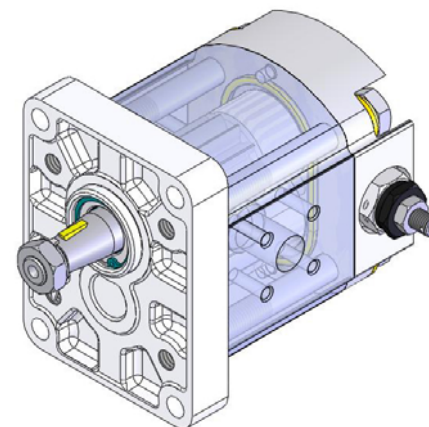

- Priority Flow divider valve

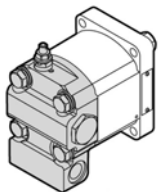

- Priority Flow divider valve + pressure relief valve

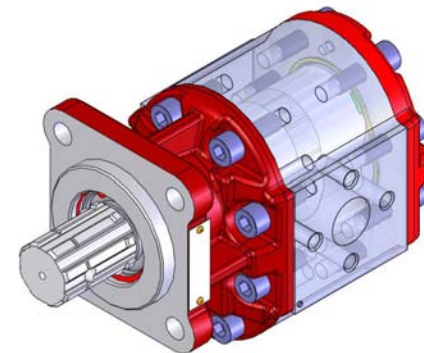



## Hand Pumps

Our factory range of hand pumps includes 4 different series featuring 10 different displacement ranges and highly advanced technical features to meet with most various applications.

- FARMING & AGRICULTURE : Suitable for trailer s dump body, for lifting forks, remote controls, etc...
- INDUSTRY: Suitable for press driving, high adjustment of working tables, hydraulic strippers, surge tanks, single and double acting jacks, etc...
- TRANSPORTATION: Mostly recommended for controlling small hydraulic jobcranes on trucks and operation of truck mixer tailrace. Also suitable for tilting of the truck cabin and emergency drives on crane trucks and aircraft platforms.

This kind of pump is essential for all emergency operations of any hydraulic equipment (specially if high technology) when a fault of the main System occurs likely to cause traffic disturbance or danger to the operators.

Our manual pumps are equipped with nickel-plated sliders allowing for operation at the maximum pressure mentioned on relevant technical tables and can be mounted both vertically and horizontally.



## Available types

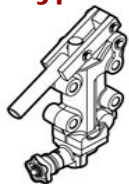

- Single acting Hand Pumps

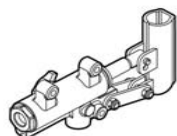

- Double acting Hand Pumps

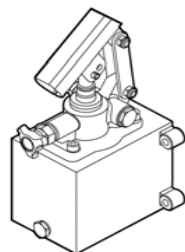
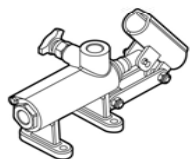

- Double acting Hand Pumps with tank





## Applications and References

Our products can be employed into further applications where it is necessary a hydraulic implant.  
The main areas where there are a greater request of Directional control Valves and Gear Pump and motor are:

**Agriculture Machines and Veicles**

**Building and Construction**

**Industrial Implants**

**Handling Machines and Veicles**

**Special Veicles**

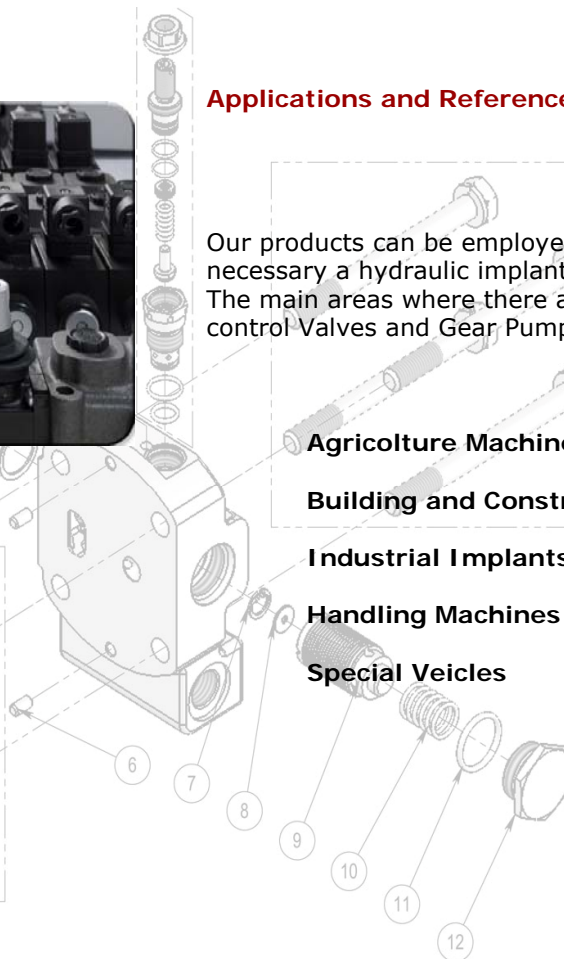
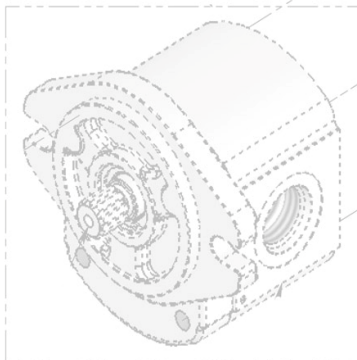



## Agriculture Machines and Veicles

- Forestry Machines
- Boom mowers
- Tractors
- Feeders
- Wagons
- Turfs
- Telehandlers
- Bale Wrappers
- Balers
- Conveyors
- Harvester Machines
- Wood Splitters



## Handling Machines and Veicles

- Cranes
- Naval Cranes
- Breakdown Trucks
- Trucks for veicles transport
- Aerial Platforms
- Veicles whit aerila platform
- Front Loaders
- Fork Lifts
- Special veicles



## Building and Construction

- Skip and hook loaders
- Backhoe
- Excavators e Mini-excavators
- Skid Steer Loaders
- Drilling Machines
- Wheel loaders
- Fork lifts
- Compactors
- Dumpers and mini-dumpers
- Concrete Mixers
- Paving Machines



## Industrial Implants

- Hydraulic Power units
- Coolers
- Mills
- Wind Mills



## Special Veicles

- Sweeper Machines
- Waste Compactors
- Snowgroomers
- Utility Veicles





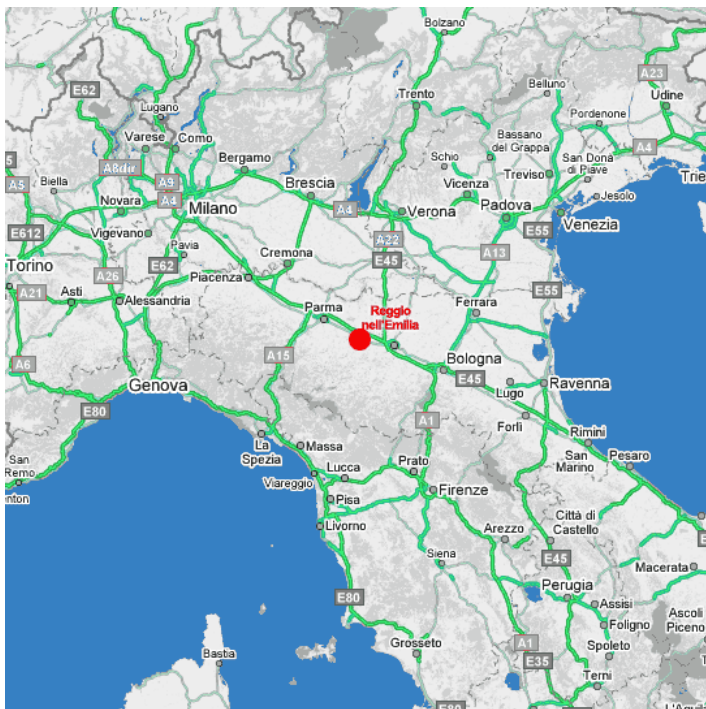

## Contacts / Headquarters

**Galtech S.r.l.**

Via Kennedy, 10 - 42124 - Reggio Emilia - Italy

Tel. +39.0522.300348

Fax +39.0522.300803

E-mail [info@galtech.it](mailto:info@galtech.it)

Web [www.galtech.it](http://www.galtech.it)

About commercial requests :

[commerciale.ita@galtech.it](mailto:commerciale.ita@galtech.it)



[sales.exp@galtech.it](mailto:sales.exp@galtech.it)

